



MODEL #5820/5821

ASSEMBLY INSTRUCTIONS AND OWNER'S MANUAL

REGISTER YOUR PRODUCT ONLINE AT WWW.LIFETIME.COM

At Lifetime, we are committed to providing innovative and quality products. While registering, you will have the opportunity to give us your feedback. Your input is valuable to us.

- You can also opt in to receive new product notifications or promotions.
- In the unlikely event of a product recall or safety modification, your registration provides the information we need to notify you directly.
- Registration is fast, easy, and completely voluntary.

Lifetime's Promise to You:

Maintaining your privacy is our long-standing policy at Lifetime. And you can rest assured that Lifetime will not sell or provide your personal data to other third parties, or allow them to use your personal data for their own purposes.

We invite you to read our privacy policy at www.lifetime.com

REGISTER today!

****U.S. and Canada customers ONLY****

**IF ASSISTANCE IS NEEDED,
DO NOT CONTACT THE STORE!!!**

CALL OUR CUSTOMER SERVICE DEPARTMENT at **1 (800) 225-3865**
HOURS: 7:00 a.m. to 5:00 p.m. Monday through Friday (Mountain Standard Time)

****Call, or visit our Web site for Saturday hours****

****For customers outside the U.S. or Canada, please contact the store for assistance.****

Save this instruction in the event that the manufacturer has to be contacted for replacement parts.

STANDARD RIM WITH SLAM-IT® HARDWARE



WARNING

To ensure your safety, do not attempt to assemble this system without reading and following all instructions carefully. Identify and inventory the parts using the Parts List. Failure to comply with any of the warnings in these instructions may result in serious personal injuries such as cuts, broken bones, nerve damage, paralysis, brain injury, or death. Failure to comply may also result in property damage. Please heed all warnings and cautions.

PARTS LIST

| ID | Part # | Description | Qty. | ✓ |
|---------------------------|---------|-------------------------|------|--------------------------|
| AA | 825608 | Orange Rim, Model 5820 | 1* | <input type="checkbox"/> |
| AA | 1018886 | Black Rim, Model 5821 | 1* | <input type="checkbox"/> |
| AB | 502005 | Net | 1 | <input type="checkbox"/> |
| AC | 502056 | Plastic Fingerguard | 1 | <input type="checkbox"/> |
| AD | 804033 | Spring Retainer Plate | 1 | <input type="checkbox"/> |
| Hardware (1038965) | | | | |
| HA | 300066 | 5/16" Hex T-Nut | 2 | <input type="checkbox"/> |
| HB | 302061 | 5/16" x 4 1/2" Hex Bolt | 2 | <input type="checkbox"/> |
| HC | 300114 | 5/16" Push Nut | 2 | <input type="checkbox"/> |
| HD | 302014 | 5/16" Flat Washer | 4 | <input type="checkbox"/> |
| HE | 302056 | Rubber Washer | 2 | <input type="checkbox"/> |
| HF | 302065 | 5/16" x 2 1/4" Tap Bolt | 2 | <input type="checkbox"/> |
| HG | 302090 | 5/16" Nylock Flange Nut | 4 | <input type="checkbox"/> |
| HH | 502060 | Compression Spring | 2 | <input type="checkbox"/> |

HARDWARE IS ACTUAL SIZE

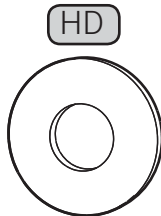
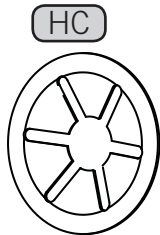
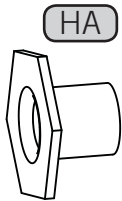

*Note: Only one Rim is included.

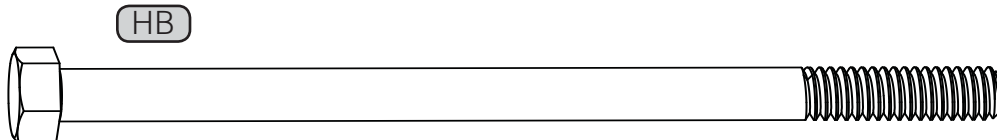
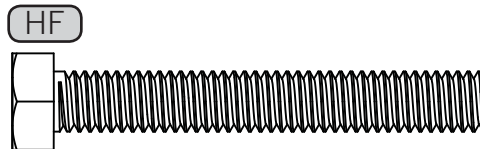
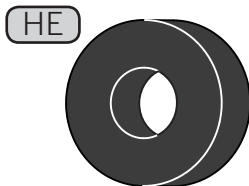

Tools Required For Assembly
(Not Included)

- 1/2" Wrenches (2)

STEP 1

- a. Slide a 5/16" Flat Washer (HD) over each of the 5/16" x 4 1/2" Hex Bolts (HB) and slide the Hex Bolts through the Spring Retainer Plate (AD). Slide the 5/16" Push Nuts (HC) onto the Hex Bolts with the convex side facing out. Slide the Push Nuts up the Hex Bolts until they reach the Spring Retainer Plate (AD).

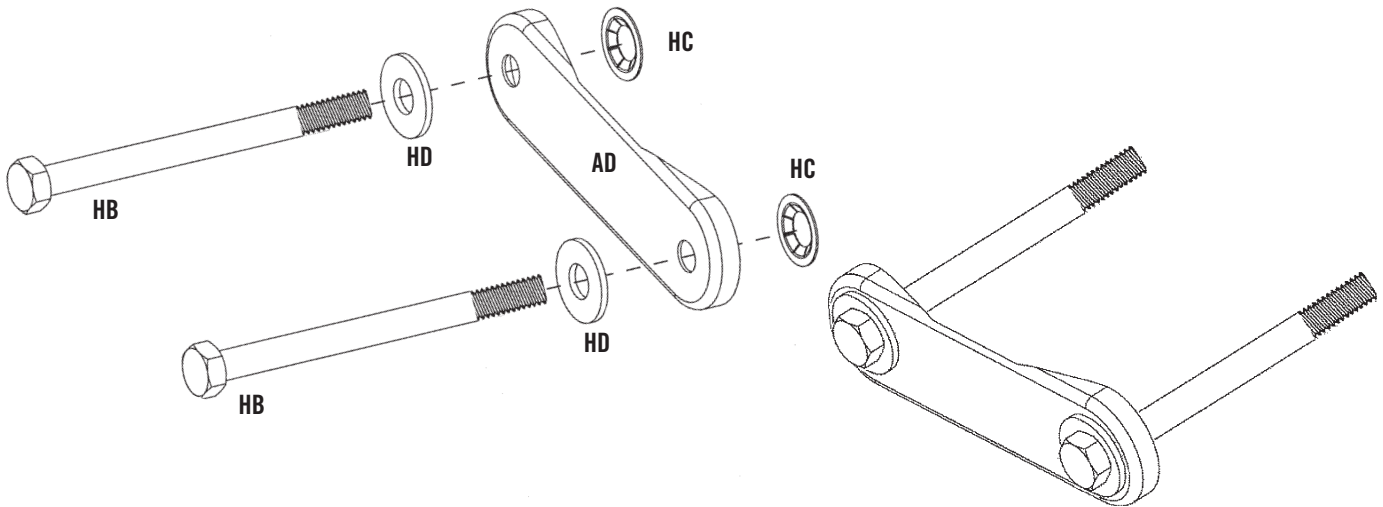

STEP 2

- a. Slide a 5/16" Flat Washer (HD) and a Rubber Washer (HE) onto each of the 5/16" x 2 1/4" Tap Bolts (HF), and then slide the Bolts through the lower holes of the Rim plate (AA). Secure the Bolts with the 5/16" Hex T-Nuts (HA). Tighten the T-Nuts just enough to slightly bulge the Rubber Washers. **DO NOT OVERTIGHTEN.**
- b. Insert the Hex Bolt/Spring Plate assembly (from Step 1) through the Compression Springs (HH) and through the upper holes of the Rim plate.
- c. Slide the Plastic Fingerguard (AC) over the four Bolts protruding from the Rim plate.

STEP 3

- a. Insert the four protruding Bolt ends through the four lower holes in the Backboard and Backboard support (not included).
- b. Secure the Bolts using the 5/16" Nylock Flange Nuts (HG). The Rim tension is adjusted by tightening the two upper Nylock Flange Nuts.
- c. Attach the Net (AB).

NOTE: Please call our Customer Service Department at the number on Page One to obtain replacement Nets. Our Nets are shorter than average to reduce the risk of entanglement.

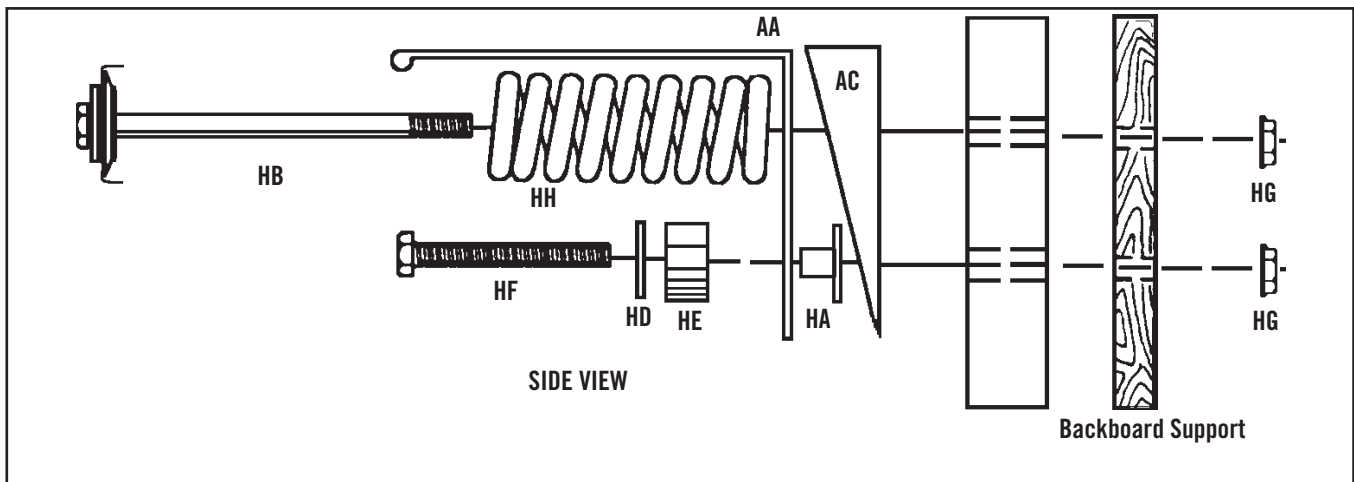

LIFETIME BASKETBALL EQUIPMENT 5-YEAR LIMITED FACTORY WARRANTY

THE MANUFACTURER RESERVES THE RIGHT TO MAKE SUBSTITUTIONS TO WARRANTY CLAIMS IF PARTS ARE UNAVAILABLE OR OBSOLETE.



1. Lifetime basketball systems are warranted to the original purchaser to be free from defects in material or workmanship for a period of five years from the date of original retail purchase. The word “defects” is defined as imperfections that impair the use of the product. Defects resulting from misuse, abuse or negligence will void this warranty. This warranty does not cover defects due to improper installation, alteration or accident. This warranty does not cover damage caused by vandalism, rusting, “acts of nature” or any other event beyond the control of the manufacturer.
2. This warranty is nontransferable and is expressly limited to the repair or replacement of defective basketball equipment. If the equipment is defective within the terms of this warranty, Lifetime Products, Inc. will repair or replace defective parts at no cost to the purchaser. Shipping charges to and from the factory are not covered and are the responsibility of the purchaser. Labor charges and related expenses for removal, installation or replacement of the basketball system or its components are not covered under this warranty.
3. This warranty does not cover scratching or scuffing of the product that may result from normal usage. In addition, defects resulting from intentional damage, negligence, unreasonable use or hanging from the net or rim will void this warranty.
4. Liability for incidental or consequential damages is excluded to the extent permitted by law. While every attempt is made to embody the highest degree of safety in all equipment, freedom from injury cannot be guaranteed. The user assumes all risk of injury resulting from the use of this product. All merchandise is sold on this condition, and no representative of the company may waive or change this policy.
5. This product is not intended for institutional or commercial use; Lifetime Products, Inc. does not assume any liability for such use. Institutional or commercial use will void the warranty.
6. This warranty is expressly in lieu of all other warranties, expressed or implied, including warranties of merchantability or fitness for use. Neither Lifetime Products, Inc., nor any representative assumes any other liability in connection with this product.

**ALL WARRANTY CLAIMS MUST BE ACCOMPANIED BY A SALES RECEIPT.
REPORT PRODUCT DEFECTS IN WRITING TO:**

Lifetime Products, Inc., PO Box 160010 Clearfield, UT 84016-0010
or call (800) 225-3865 M-F 7 a.m. to 5 p.m. MST.

Please include your dated sales receipt and photographs of damaged parts.

To Register Your Product, Visit Our Website at www.lifetime.com